

**PERFORMANCE:**

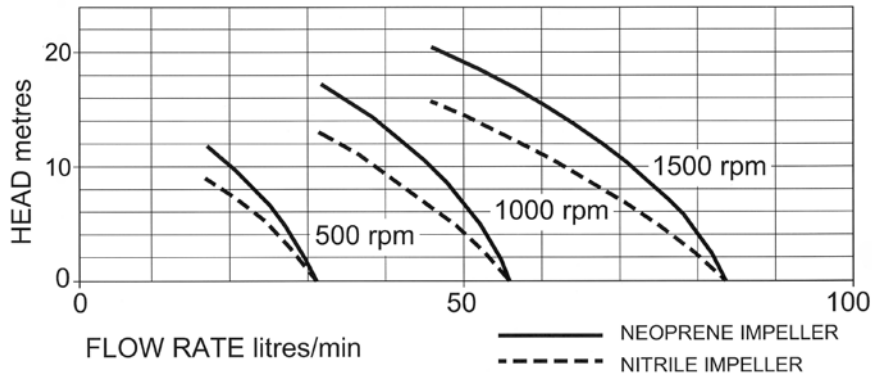

MODEL	Maximum flow rate		Maximum head	
	l/min	gall/min	metres	feet
50580-2**1	82	18	20	65
50580-2**3	82	18	18	59

Max Power absorbed 550 watt at 1500rpm

**DIMENSIONS:**

**WEIGHT: 7.5 Kg**

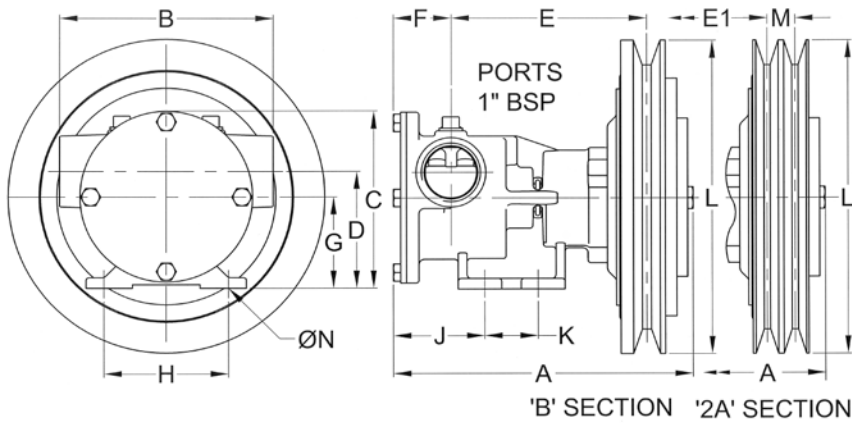

A	B	C	D	E	E1	F	G	H	J	K	L	M	N
168	120	101	67	110	103	32	52	70	51	30	178	15.8	Ø9

**MATERIALS OF CONSTRUCTION:**

<b>Body</b>	Bronze
<b>Impeller</b>	Neoprene or oil resistant Nitrile
<b>Wearplate</b>	Replaceable
<b>Shaft</b>	Stainless steel type 316
<b>Shaft seal</b>	Mechanical, carbon/ceramic
<b>Bearings</b>	Twin row, ball type
<b>Port type</b>	1" BSP to BS21 (DIN2999)
<b>Clutch type</b>	Electro-magnetic 12v or 24v dc
<b>Pulley</b>	178mm dia A or B section

**MODELS:**

- 50580-2001 12v 2A groove, Neoprene Impeller
- 50580-2101 24v 2A groove, Neoprene Impeller
- 50580-2201 12v 1B groove, Neoprene Impeller
- 50580-2301 24v 1B groove, Neoprene Impeller
- 50580-2003 12v 2A groove, Nitrile Impeller
- 50580-2103 24v 2A groove, Nitrile Impeller
- 50580-2203 12v 1B groove, Nitrile Impeller
- 50580-2303 24v 1B groove, Nitrile Impeller



a xylem brand

**BRONZE FLEXIBLE  
IMPELLER ELECTRO  
MAGNETIC CLUTCH**

**50580 SERIES**



**PUMP with (Mech Seal)  
1" BSP PORTS**

- \* Constructed from marine quality bronze and stainless steel
- \* Self-prime from dry up to 2.4m
- \* Easy to service and maintain
- \* Will tolerate abrasive wear
- \* Handles hard and soft solids without clogging
- \* Can pump in either direction
- \* Will not airlock

Xylem Water Solutions UK Ltd  
Bingley Road  
Hoddesdon  
Hertfordshire • EN11 0BU UK

Tel: +44 (0)1462 480380  
Fax: +44 (0)1462 482422  
mail@cleghorn.co.uk  
www.jabscoshop.com

