

ISOTTA

HEATED STEERING WHEEL

Fitting instruction
Wiring connection

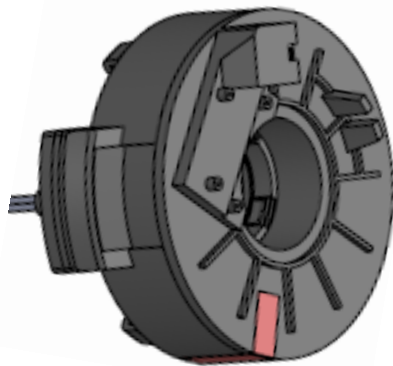

Important note:

supplied clockspring is equipped with a **SECURITY LABEL**.
This label should only be removed when specified in the
instructions below.

DO NOT REMOVE THE LABEL BEFORE indicated.

1

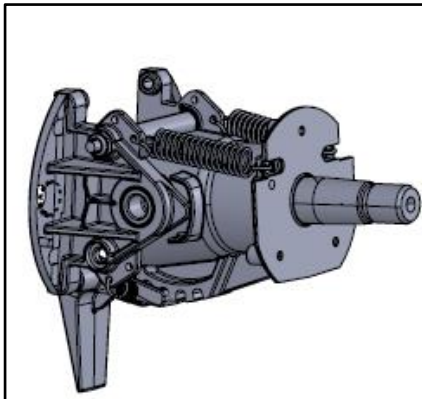

For Seastar application: temporarily remove the original Tilt Helm plastic cover. If not done yet, make the thread in the 3 holes.

2

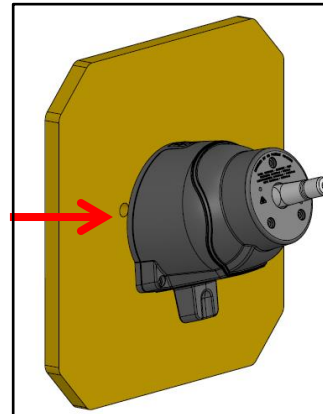

Make correct side hole by following supplied template (ref. page 4 of this manual)

3

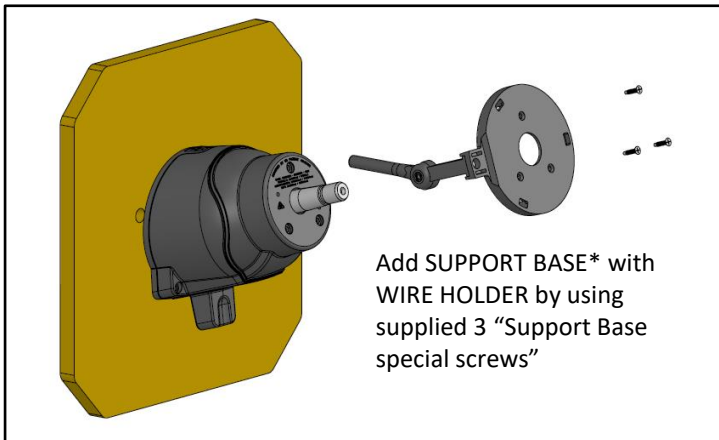

Add SUPPORT BASE* with WIRE HOLDER by using supplied 3 "Support Base special screws"

4

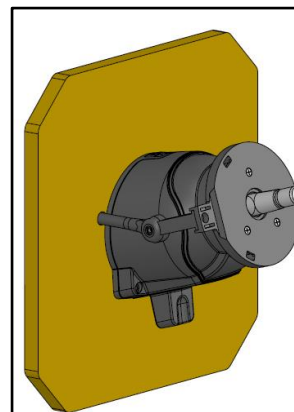

Align shaft with the engine
To proceed with installation, the shaft must be at the **CENTER** position, exactly in the middle of the engine «lock-to-lock» position.

** Remind to use the correct SUPPORT BASE for your system (ask your agent for more details)*

5

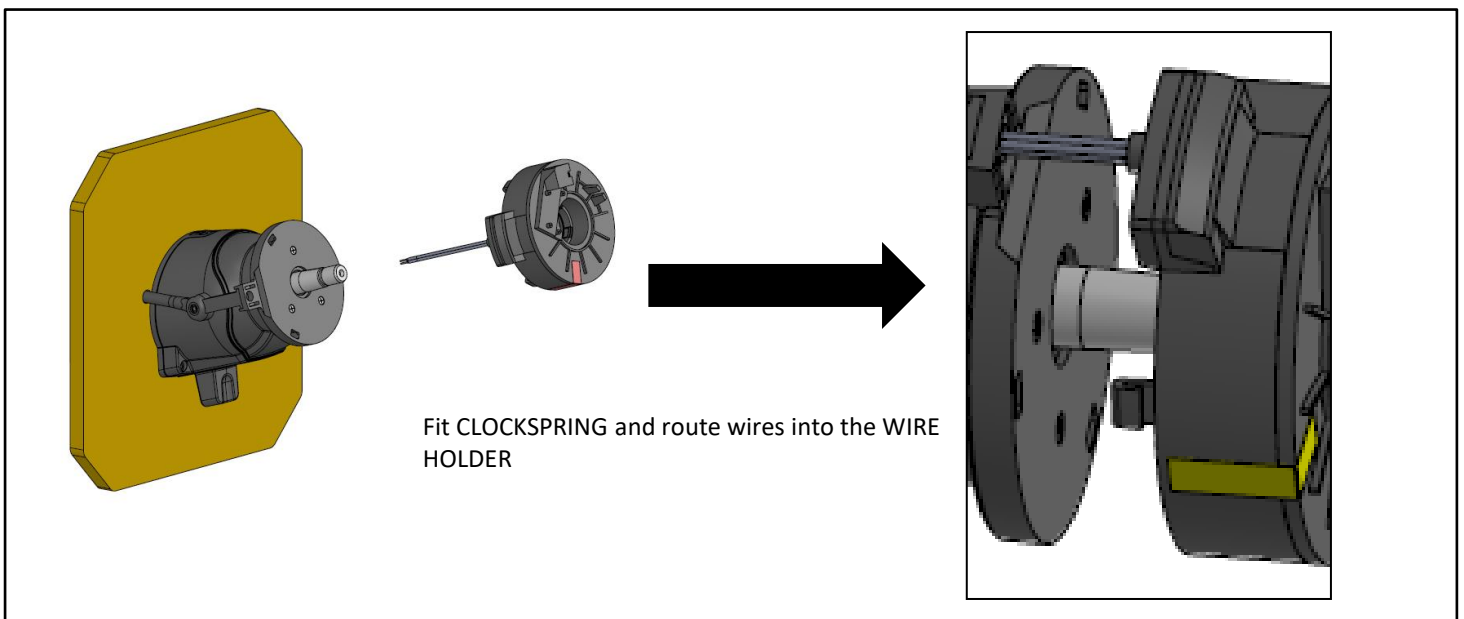

Fit CLOCKSPring and route wires into the WIRE HOLDER

6

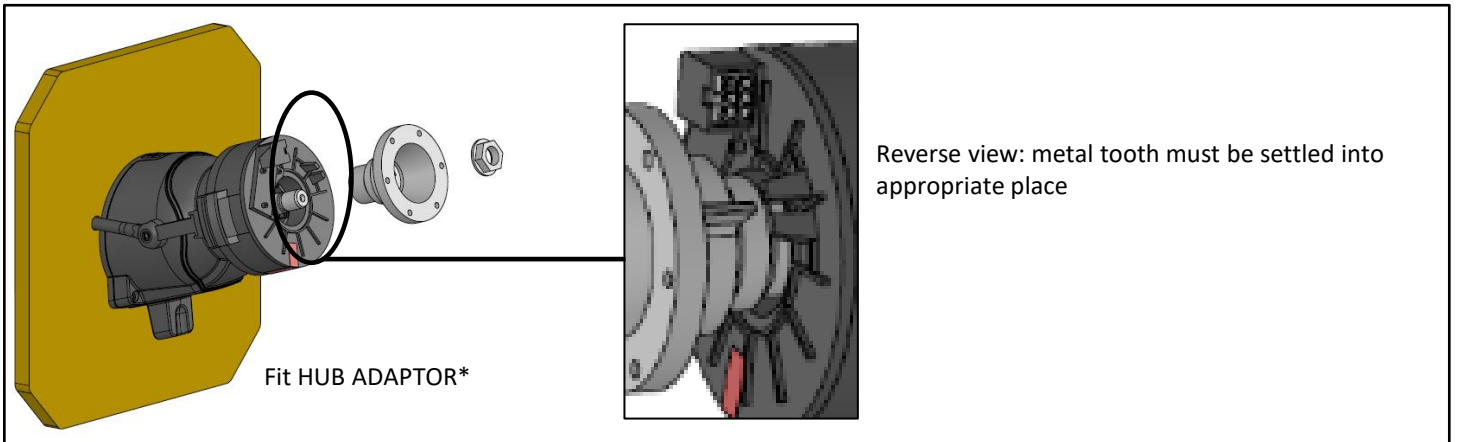

* Remind to use the correct HUB ADAPTOR for your system (ask your agent for more details)

7

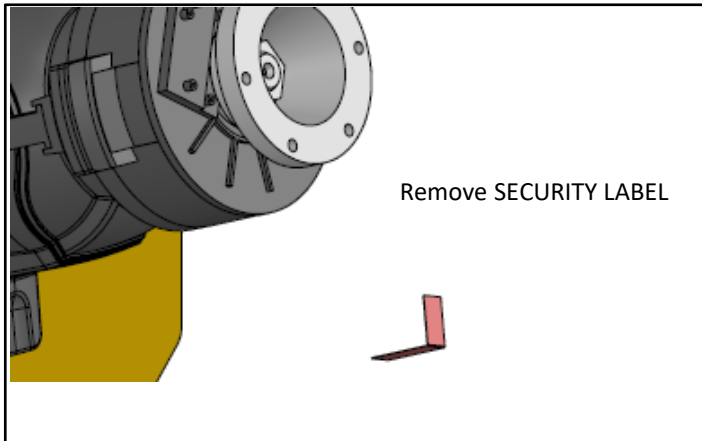

8

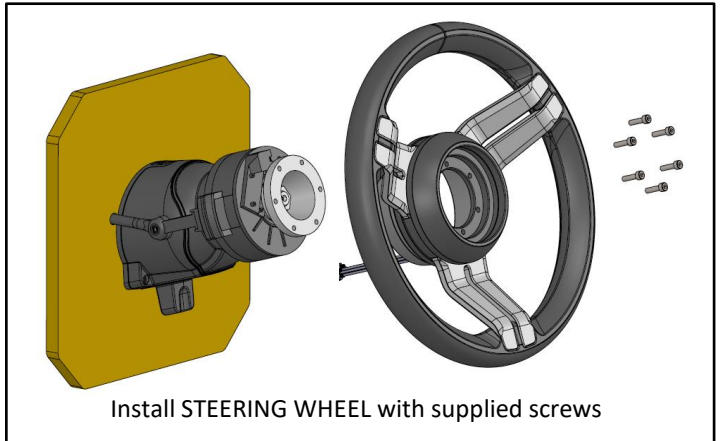

9

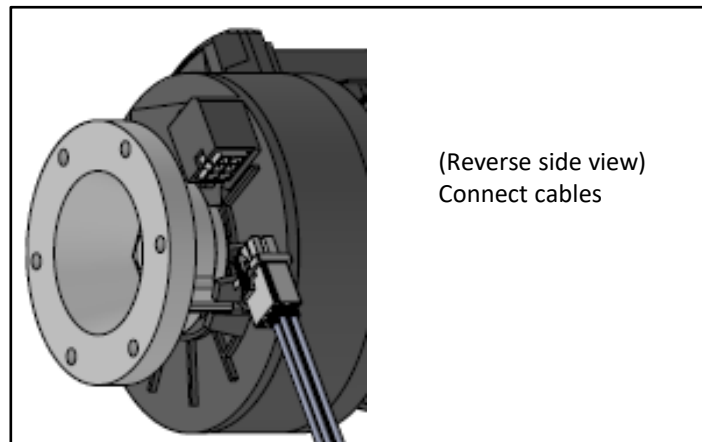

10

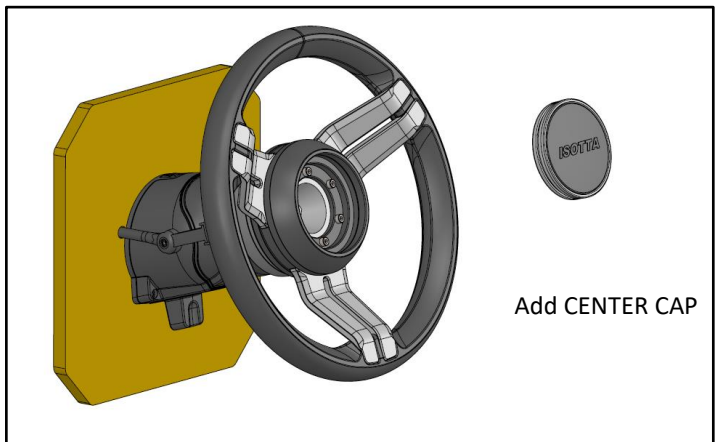

TEMPLATE

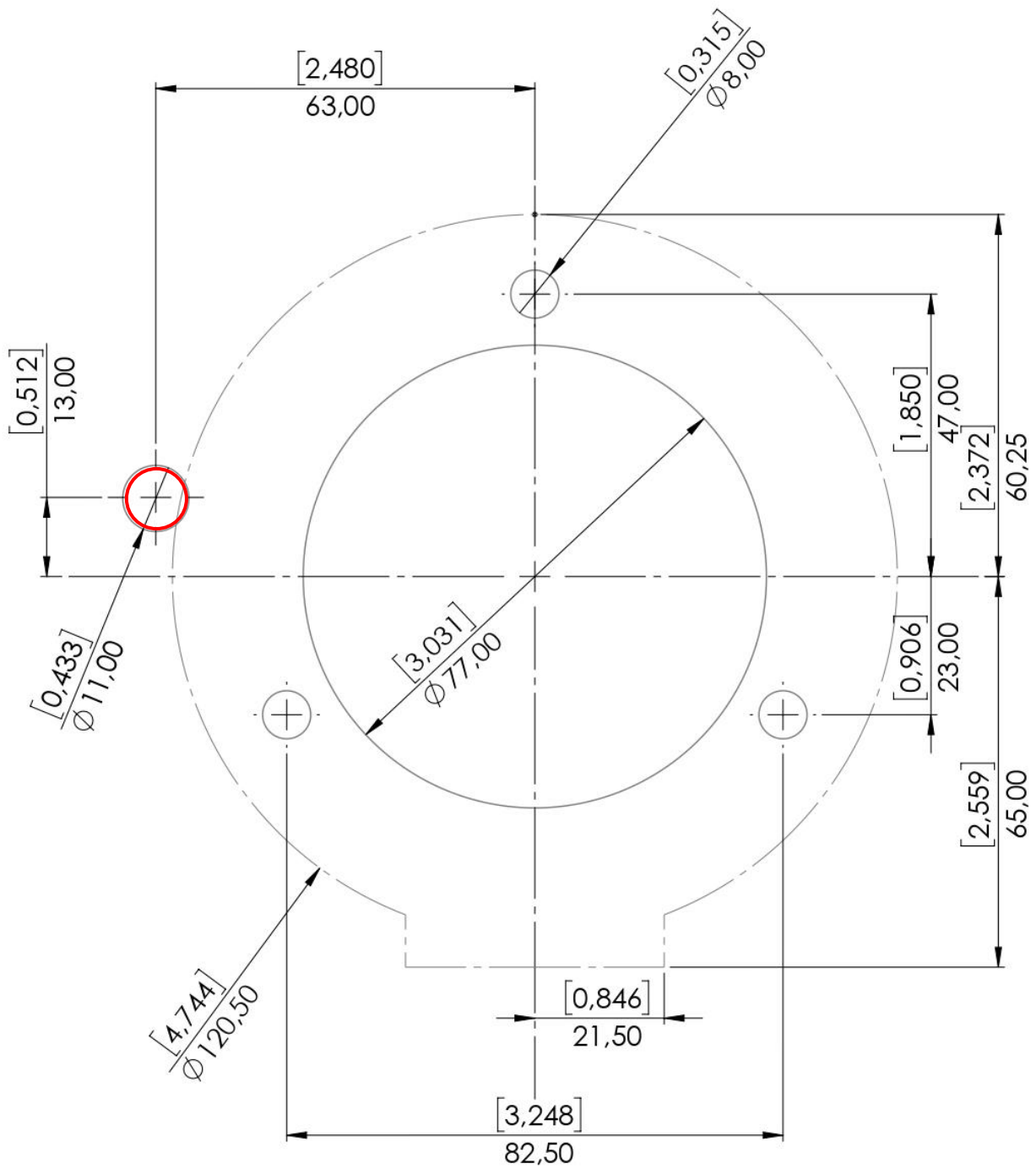

WIRING CONNECTION

(version with standard on/off button)

1 = Connect steering wheel cable to ECU

2 = Connect ECU to Relay CABL_SEM

3 = Connect Relay to ON/OFF button

4 = Connect Relay to Battery

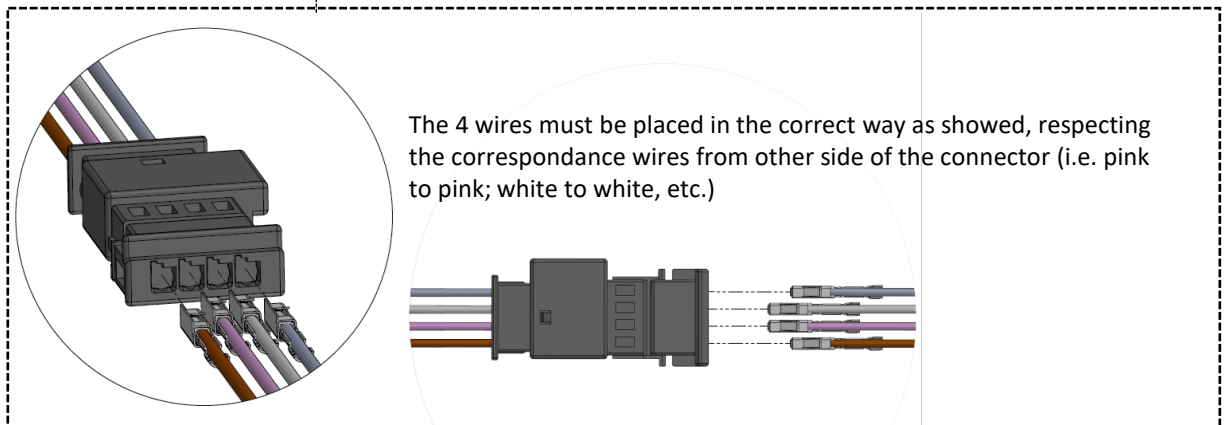
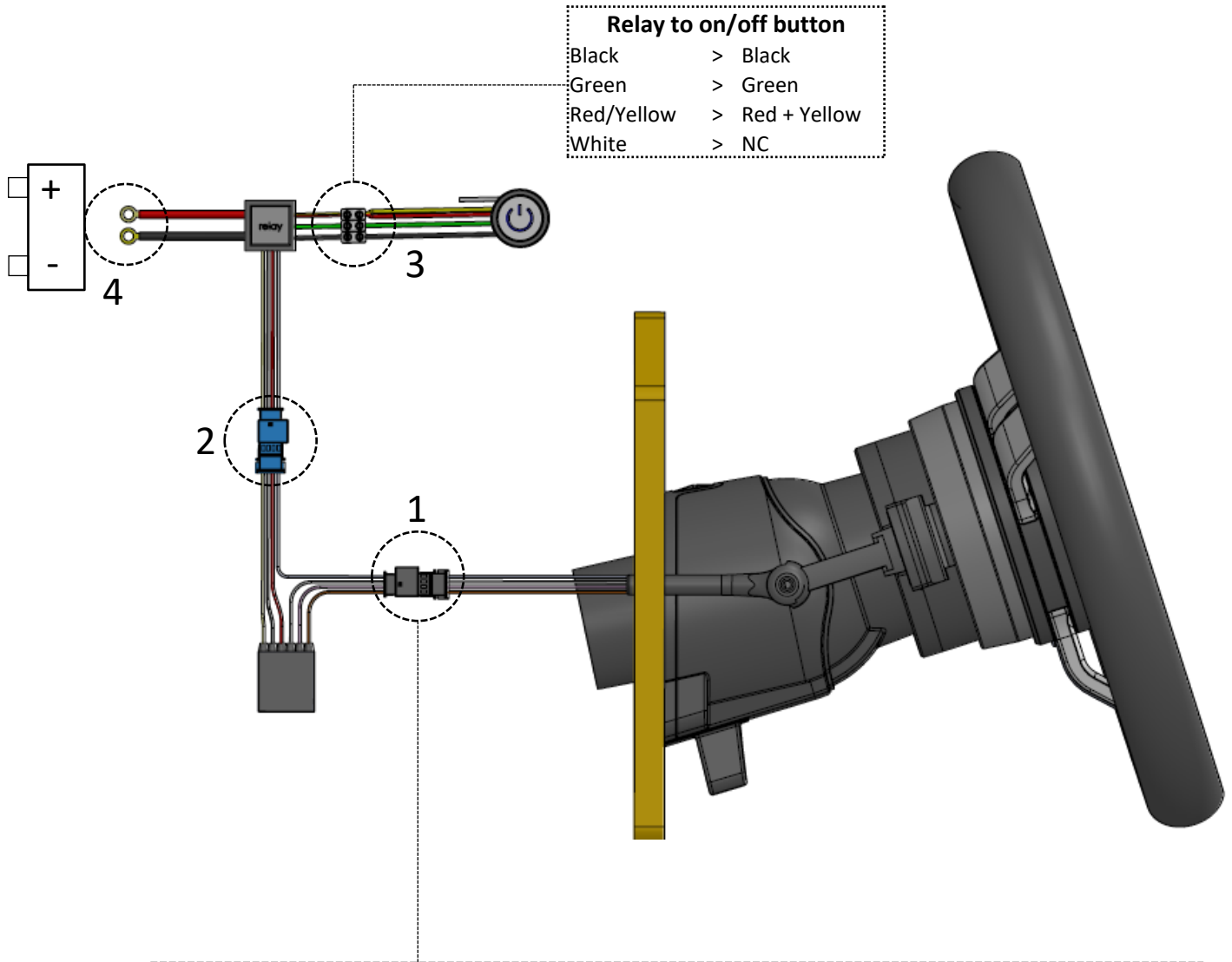

ELECTRICAL FEATURES

Description	Min.	Nom.	Max.	Unit
Vbatt Operating voltage range	9.0	13.5	16.0	V
Operating temperature range	-40	25	+85	°C
Maximum Vbatt current draw			8.0	A
Current draw without HEATER active. (Steady state of temperature control in HIGH/LOW mode)	5	8	10	mA
Target temperature heating level "HIGH"		48		°C
Target temperature heating level "LOW"		44		°C
HIGH/LOW input Operating voltage range	9.0	13.5	16.0	V
HIGH input current absorption		200		mA
LOW input current absorption		400		mA
Fuse breaking capacity (10A suggested value, the fuse can be replaced)	10			A

STANDARD ON/OFF BUTTON

22mm Stainless Steel Momentary Push Button 12V-24V 5A LED 1NO1NC SPDT ON Off Waterproof with Wire Socket Plug (Red LED)

Hole thread:M22*1

