

Deck Foot Switch Instructions

To be retained

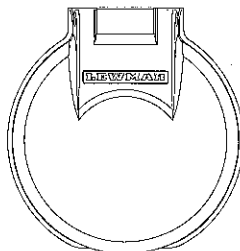
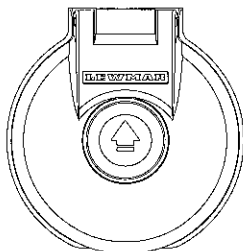

Switches should be fitted in accordance with these instructions AND Lewmar instruction manual for the equipment being operated.

This deck switch is for use with Lewmar 12V & 24V DC product control systems.

Applicable to Deck Switch Models:

68000970 Footswitch Open Grey
68000928 Footswitch Assy Grey Blank
68000883 Footswitch Assy Grey Down
68000884 Footswitch Assy Grey Up

68000929 Footswitch Assy SS Blank
68000889 Footswitch Assy SS Up
68000888 Footswitch Assy SS Down

68000971 Footswitch Open White
68000930 Footswitch Assy White Blank
68000918 Footswitch Assy White Down
68000917 Footswitch Assy White Up

Specification

Operating Voltage Range:	9 V to 32 V dc only.
Max switching current:	5 Amps
Switch Type:	Normally-Open Momentary contact
Wire Size:	1mm ²
Switch contact life	100,000 operations

Wiring diagram

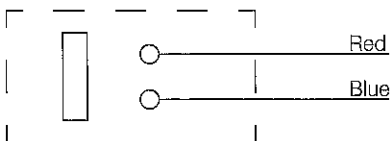

Switch contact
momentary
normally - open
5A Max

Installation

⚠ WARNING!

All electrical equipment work must be carried out by a qualified electrician
All electrical power must be isolated before work is carried out

- Disconnect Power.
- Switches must be fitted to a flat surface $\pm 1\text{mm}$.
- Use supplied mounting template/information – drill a 10mm (3/8") diameter hole for the wires.
- Use a suitable marine-grade sealant to mate switch and deck surfaces.
- Fix the switch to the deck using the self-tapping screws supplied.
- Use an even force on all 3 fixings, do not over-tighten.
- Make electrical connections as per product manual.
- Follow relevant standards and guidelines for electrical installations; use ISO 10133 as minimum.
- See Inspection & Maintenance instructions before use.

Notes:

- Switch is for use in DC voltage systems only.
- If installed in vessel containing AC circuits follow ISO 10133 for correct wiring installation
- Switch is not intended for use in ignition protected areas.
- It is the responsibility of installer to maintain waterproof sealing through deck upon installation.

Operation

- Operation of switch must be in accordance with instructions and warnings in product manual.
- Deck switches are designed to be used in conjunction with Lewmar equipment only. If they are to be used for the powering of any other electrical equipment the intended use should be checked against the specification of the switch.
- Deck switches should only be operated with fingers, bare feet or soft soled shoes. Switch may be finger operated through lid on open access version. Lift lid to operate switch by foot, close lid after use. Do not use hard soled shoes or sharp objects to operate switch
- Switches should be left with the lid closed to minimise environmental degradation and the potential for accidental operation or impact damage.
- Powered equipment should always be isolated when not in use to prevent accidental start up.
- The instructions for the equipment being operated should always be read and followed.
- Power washers should not be used on or near any switch.
- It is acknowledged that deck switches will need to be washed down as part of a deck cleaning process. However, direct flow from a non pressure hose should not be aimed at the switch.
- The deck switch itself should only be cleaned with a mild soap and washed off immediately with a light application of fresh water.
- The following (non exhaustive) list of substances should not be applied, or used on or near any deck switch. Products include but are not limited to:-
 - Chemicals
 - Deck cleaners
 - Petroleum based fluids/cleaners
 - Deck polish
 - Deck brightener
 - Varnish/lacquers/paints
 - Oil

Warnings and Good Practice

Electric deck switches operate in a hostile environment and are subject to salt water, extremes of temperature, direct sunlight and UV effect. They are also susceptible to wear and tear following repeated use and can in some instances suffer accidental damage during boat operations. It is therefore recommended that regular visual and functional inspection of the switch, the circuitry and the equipment being controlled is carried out by a competent qualified person on a regular basis.

If any defects are noted on the switch (see point 2.0 below), replacement is mandatory so as to avoid the possibility of a malfunction. It is further recommended that an item of this nature is not intended to remain in service forever. The lifespan will depend upon the weather and UV conditions to which the switch is exposed, as well as the amount of use. Therefore, a service lifespan of 3 to 5 years from date of purchase can be expected, after which time it should be replaced. Shorter lifespans could be experienced and the following inspection recommendations are therefore important in ensuring continuing safe operation.

Inspection

1.0 - The deck switch and the system it controls should be fully tested in a 'No Load' condition prior to full functional operation as per its design purpose, before every trip, activity or task. Only after the skipper has satisfied themselves of the safe and functional operations should the equipment be used.

2.0 - The deck switch should be inspected pre-departure or use paying particular attention to the following:

- 2.1 Ensure there is no visible damage to the switch.
- 2.2 Ensure there is no noticeable wear to the switch, housing, button or fixings.
- 2.3 Ensure the rubber membrane over the switch is not sticky or has any deposits or residue from cleaning fluids or other prohibited materials.
- 2.4 Ensure the rubber membrane over the switch does not show any signs of cracks, splits or degradation.
- 2.5 The main switch housing should not have any visible chips or cracks.
- 2.6 Ensure there is no change to the smooth, positive feel of the switch.
- 2.7 There should be no signs of water ingress on any part of the switch assembly.
- 2.8 Ensure that the fixings screws and seal to the deck bulkhead or coach roof are secure, and remain effective in both securing the switch and preventing water ingress.
- 2.9 The switch should not feel spongy and should not make a squealch or bubbling noise due to water ingress when depressed and operated.

Maintenance

If any of the points highlighted in 2.0 through to 2.9 are detected during inspection, the deck switches should not be used and should be replaced.

3.0 - On an annual basis the deck switch should be removed by a qualified electrical technician to carry out the following:

- 3.1 All the checks detailed in 2.0 – 2.9 above
- 3.2 Inspect the underside of the deck switch for signs of corrosion, damage or water ingress
- 3.3 Inspect the wiring for signs of loose connections or corrosion
- 3.4 In open circuit mode (OFF) condition, the resistance should be checked for a recording on the test meter beyond measurement to confirm no electrical connection.
- 3.5 In closed circuit mode (ON) condition, the resistance should be less than 3 Ω (ohms)
- 3.6 If the switch shows any signs of excessive wear, degradation in its action, water ingress or loss in electrical resistance properties, it should be changed immediately.

Additional Guidance

4.0 - It is the responsibility of the skipper to ensure that crew members are trained in the operation of powered deck equipment and use it in a safe and appropriate way within its designed operating parameters. This includes what to do in an emergency.

4.1 It is the responsibility of the skipper to ensure that crew members are appropriately briefed on all three methods of equipment isolation in event of emergency, i.e :-

- 4.1.1 The switch itself and its operation.
- 4.1.2 The circuit breaker on main panel.
- 4.1.3 The main battery isolation.

4.2 Crew briefings should always cover the following issues pertaining to deck switch operated equipment:-

- 4.2.1 Safe operation of any powered deck equipment.
- 4.2.2 What to do in the event of an emergency
- 4.2.3 What not to do in event of emergency
- 4.2.4 A practical demonstration of the effective isolation of deck equipment as highlighted in point 2 above

UK & International Distribution

Southmoor Lane, Havant
Hampshire, PO9 1JJ
UK

Tel: +44 (0)23 9247 1841
Email: info@lewmar.com

USA

TaylorMade Products
65 Harrison Street
Gloversville
NY 12078
USA

Tel: +1 203 458 6200
Email: info@lewmar.com

www.lewmar.com

DECK FOOT SWITCH

D Dieser Fußschalter ist für elektrische GS-Ankerwinden, die mit 12 bzw. 14 Volt betrieben werden, geeignet.
Er ist durch einen Klappdeckel vor unabsichtlicher Betätigung geschützt. Schließer, 5 Ampere 12 & 24 Volt. Installationsbereit. Muss mit einem Schaltschütz oder Schaltkasten verwendet werden.

INSTALLATION

1. Klemmen Sie die Batterie ab.
2. Bohren Sie mit Hilfe der unten befindlichen Montageschablone ein 9,5mm (3/8") großes Loch für die Drähte.
3. Befestigen Sie den Schalter mit Hilfe der mitgelieferten Blechschrauben am Deck. Zur Versiegelung des Schalters ist eine gleichmäßige Krafteinwirkung erforderlich.
4. Nehmen Sie die elektrischen Anschlüsse wie in unterstehender Abbildung gezeigt vor.
5. Schließen Sie die Batterie wieder an und testen Sie den Schalter auf fehlerfreie Funktion.

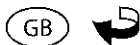

E Este interruptor actuado por el pie se usa en los cabrestantes eléctricos tipo DC que funcionan a base de 12 o 24 voltios.
El interruptor tiene una tapa con bisagra para impedir cualquier funcionamiento producido por accidente.
Normalmente tiene un contacto abierto, de 5 amperios de 12 y 24 voltios. Viene listo para ser instalado. Tiene que usarse con una caja de contactos o de control.

INSTALACIÓN

1. Desconectar la batería.
2. Coger la plantilla de soporte descrita abajo y taladrar un agujero de 9,5 milímetros (mm. = 3/8") para los alambres/cables.
3. Sujetar el interruptor a la cubierta utilizando los tornillos auto-clavables ya incluidos. Se necesita una presión uniforme para sellar bien el interruptor.
4. Rematar las conexiones eléctricas tal como se describe en el gráfico adjunto.
5. Volver a conectar la batería y hacerle una prueba para verificar el funcionamiento correcto.



S Denna fotreglerade strömbrytare är lämpad för likströmsvinschar på 12 eller 24 volt.
En skydd, som sitter på gångjärn, förebygger uppstartande av misstag.
Normalt öppen kontakt, 5 Amp, 12 & 24 volt.
Färdig för installation. Måste användas med Brytare eller Kontrollenhet.

INSTALLATION

1. Koppla ur batteriet.
2. Använd monteringsmallen (nedanför), borra ett 9,5 mm (3/8") hål för kablarna.
3. Fäst strömbrytaren vid däck med hjälp av de självpluggande skruvarna som medföljer. Jämnt tryck krävs för att försegla strömbrytaren.
4. Använd diagrammen nedan för att installera de elektriska anslutningarna.
5. Koppla i batteriet igen och testa korrekt uppstartande.



LEWMAR®

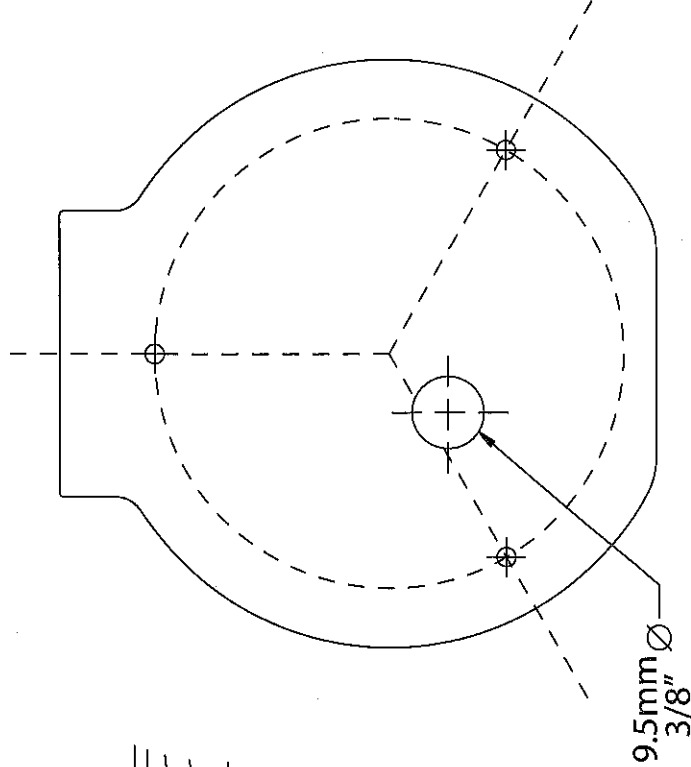
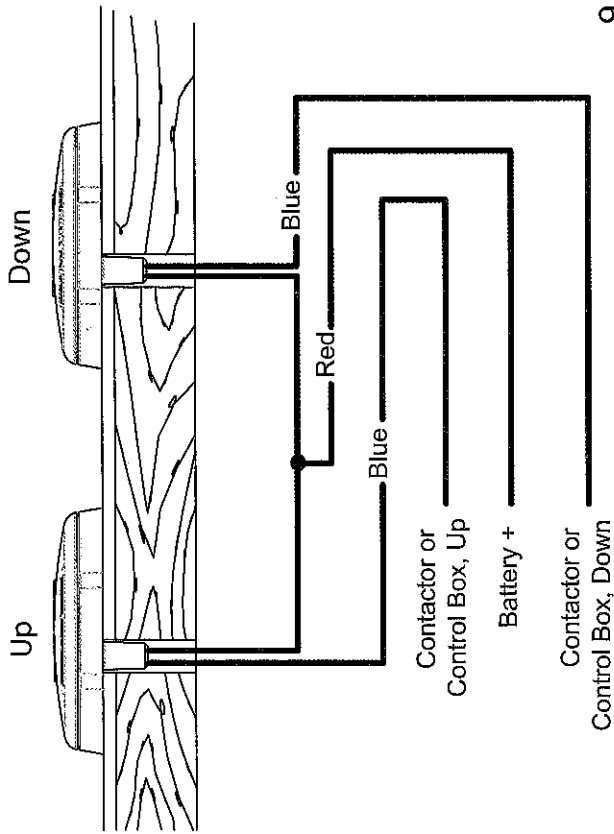

ACTUAL SIZE

	(GB)	(I)	(F)	(D)	(E)	(S)
Red	Red	Rosso	Rouge	Rot	Rojo	Röd
Blue	Blu	Blu	Bleu	Blau	Azul	Bla
Up	in alto	in alto	vers le haut	Auf	Ariba	Upp
Down	in basso	in basso	vers le bas	Unten	Abajo	Net
Battery	Batteria	Batterie	Batterie	Batterie	Batería	Batteri
Contactor	Contattore	Interrupteur à distance	Schalterschütz	Gaja de contactos	Brytare	
Control Box	Scatola di controllo	bôte de commande	Schaltkasten	Control	Kontrollenhet	