



# NEW GENERATION "HEAVY DUTY" DOCKING LIGHT INSTALLATION INSTRUCTIONS

for AP#'s 95001, 95021, 95013 & 95018

AP Docking Lights are flush-mounting, marine lighting units designed for general illumination below the deck line and can be used in any numbers, depending upon individual requirements.

AP Docking Lights are equipped with an easily changeable sealed beam lamp assembly that projects a light beam of approximately 7 degrees in height and 40 degrees in width, with lesser amounts to the sides and downward.

## 1. DETERMINE MOUNTING LOCATION

- 1.1 Mark a light, vertical line on the outside of the hull about 30" (76.2cm) back from the bow. Mark the location of any ribs or other items that may interfere with the lights and relocate, if necessary.

**NOTE: DO NOT ALLOW THE BOAT REGISTRATION NUMBERS TO INFLUENCE THE LOCATION OF THE LIGHTS. THE NUMBERS CAN BE RELOCATED TO ANY CONVENIENT LOCATION.**

- 1.2 Mark a line on the outside of the hull approximately 10" (2.54cm) below and parallel to the rub rail or hull planking.
- 1.3 Tape the templates (see Figure 1) on the horizontal lines.
- 1.4 Hold each docking light in the same position as the template and vary the location of the lamp assembly within the housing. If more that 50% of the lamp lens can be seen from a position 20 to 30 feet (6.1 to 9.1m) ahead and 2 feet (61cm) above the waterline, the location is correct. If necessary, change the location of the template until at least 50% of the lens can be seen.

## 2. CUT MOUNTING HOLES

- 2.1 Drill two 1/8" (3.2mm) diameter holes at the aft and forward edge of the shaded cutout area on each template. Using these two holes for reference points check the inside of the hull for sufficient clearance to install the lights. If necessary, change the template location to obtain required clearance.
- 2.2 Mark the cut-out line on the hull with a center pinch, or by locating the center punch holes on the hull and scribing cutout lines with a pair of dividers.
- 2.3 Cut along the inside of the cut-out line with a keyhole or saber saw.
- 2.4 Use the housing as a template to mark the location of the mounting holes with a pencil. In each of the marked hole locations drill a 9/32" (7mm) hole.

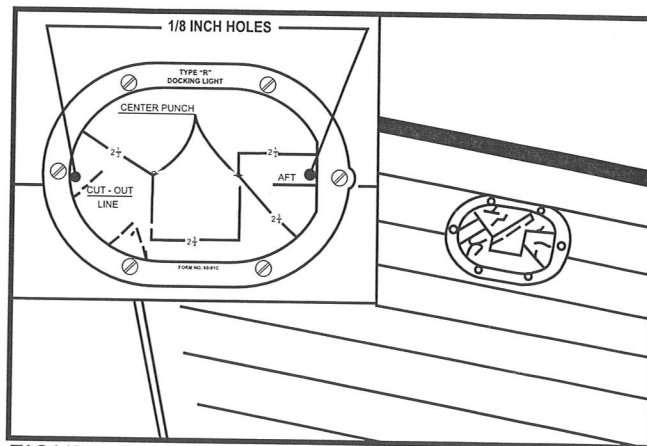

FIGURE 1

**NOTE: DO NOT USE THE DOCKING LIGHT HOUSING AS A DRILL JIG. THE DRILL MAY DAMAGE THE HOUSING**

- 2.5 Lapstrake hulls require a shim made from marine grade plywood or other suitable material and attached to the hull with seam compound and mechanical fasteners. The fasteners must be positioned not to interfere with the housing mounting screws. See Figure 2

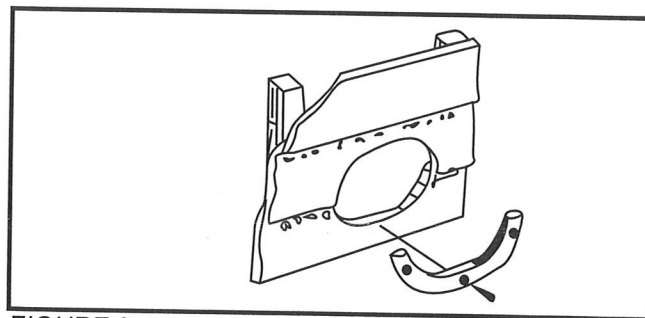

FIGURE 2

## 3. MOUNTING THE DOCKING LIGHTS

- 3.1 Fill the channel in the rear of the housing with seam compound. Place the housing into the hull opening, insert the screws (coated with seam compound) provided into the mounting holes and secure from the inside of the hull with the washers and lock nuts provided.

**NOTE: SPECIFICATIONS AND FEATURES ARE SUBJECT TO CHANGE WITHOUT NOTICE.**

3.2 Tighten the screws evenly and gradually until the housing is snug against the hull. DO NOT OVER TIGHTEN. Wipe off excess compound from around housing.

#### 4. WIRING

4.1 Following A.B.Y.C. STANDARDS AND RECOMMENDED PRACTICES FOR SMALL CRAFT Use appropriate wire type and gauge for the length of your wire run. Figure 3.

4.2 Mount switch in an easily accessible location at the helm.

##### 12 VOLT SYSTEM

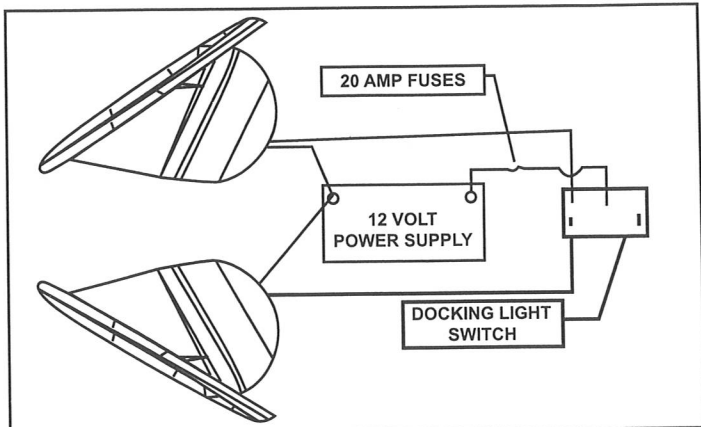

##### 32 VOLT SYSTEM

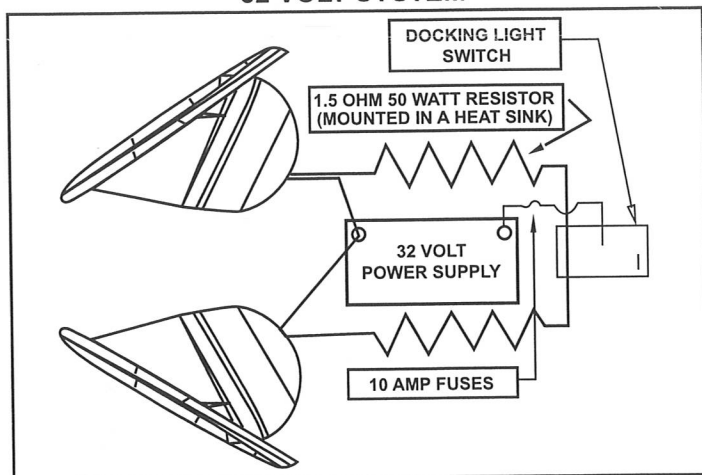

Figure 3

#### 5. ADJUSTMENT

5.1 Loosen the set screw and adjust each Lamp Assembly to cover "dead ahead" to 40 degrees to each side on the surface of the water 50 to 75 feet (15 to 23m) forward of the bow. Tighten set screw.

The lettering on the front of the sealed beam lens MUST BE upright so the beam pattern will be horizontal.

**NOTE: DO NOT OVER TIGHTEN SET SCREW**

5.2 Proper adjustment will provide an even band of light 80 degrees wide "dead ahead", as hown in Figure 4

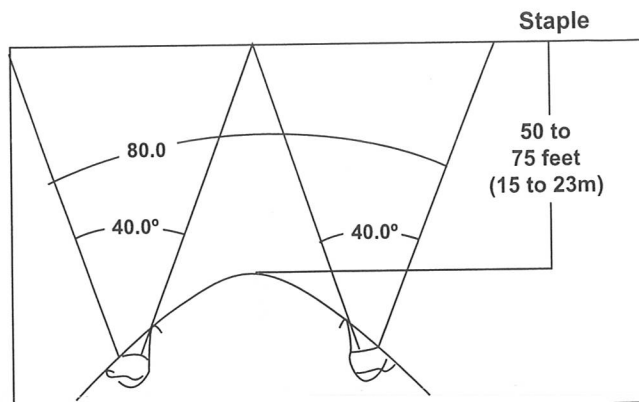
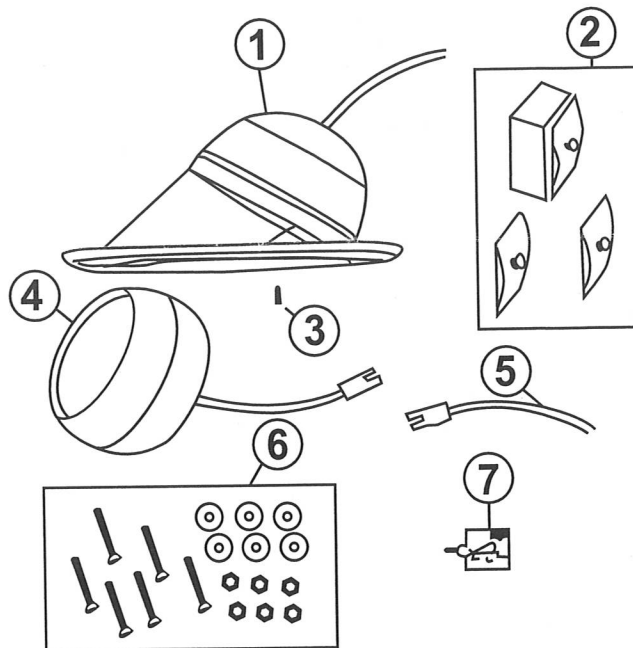

Figure 4

**CAUTION:** DOCKING LIGHTS HAVE THE SAME BRILLIANCE AS SEARCHLIGHTS AND ARE COVERED BY THE SAME REGULATIONS. THEREFORE, THEY SHOULD BE USED WITH THE SAME CAUTION AS ANY LIGHT USED AT NIGHT ON THE WATER.



ITEM	DESCRIPTION	AP#
1	HOUSING	
	WHITE	95005
	BLACK	95017
2	SWITCH KIT	3500
3	STAINLESS STEEL SET SCREW	95003
4	LAMP ASSEMBLY	
	12V WHITE	95002
	12V BLACK	95016
	28V WHITE	95004
	28V BLACK	95019
5	HOUSING ELECTRICAL HARNESS	95007
6	HARDWARE KIT	95006
7	ALLEN WRENCH (3/32")	95020