

PERFORMANCE:

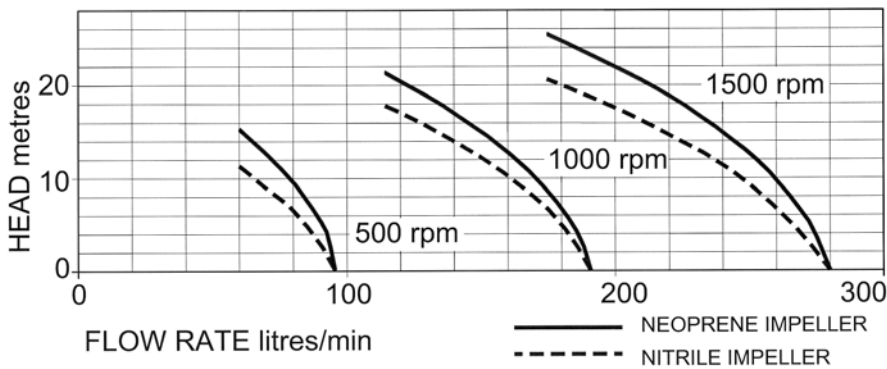

MODEL	Maximum flow rate		Maximum head	
	l/min	gall/min	metres	feet
50270-2**1	300	66	25	82
50270-2**3	300	66	20	65

Max Power absorbed 1800 watt at 1500rpm

DIMENSIONS:

WEIGHT: 12.2Kg

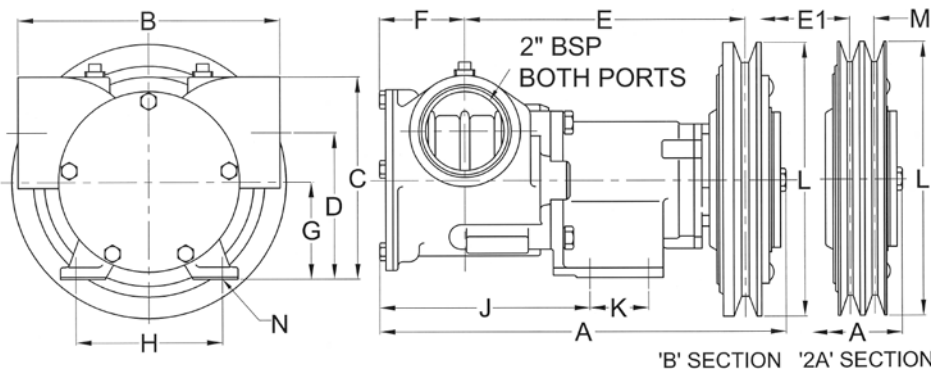

A	B	C	D	E	E1	F	G	H	J	K	L	M	N
264	170	132	96	182	174	56	64	95	136	38	Ø178	15.8	Ø10

MATERIALS OF CONSTRUCTION:

Body	Bronze head, Cast Iron bearing housing
Impeller	Neoprene or Nitrile
Wearplate	Replaceable
Shaft	Stainless steel type 316
Shaft seal	Mechanical, Carbon-Ceramic
Bearings	Twin single row, ball type
Port type	2" BSP to BS21 (DIN2999)
Clutch type	Electro-magnetic 12v or 24v dc
Pulley	178mm dia A or B section

MODELS:

- 50270-2011 12v 2A groove, Neoprene Impeller
- 50270-2111 24v 2A groove, Neoprene Impeller
- 50270-2211 12v 1B groove, Neoprene Impeller
- 50270-2311 24v 1B groove, Neoprene Impeller
- 50270-2003 12v 2A groove, Nitrile Impeller
- 50270-2103 24v 2A groove, Nitrile Impeller
- 50270-2203 12v 1B groove, Nitrile Impeller
- 50270-2303 24v 1B groove, Nitrile Impeller



a xylem brand

**BRONZE FLEXIBLE
IMPELLER ELECTRO
MAGNETIC CLUTCH**

50270 SERIES



**PUMP with
2" BSP PORTS**

- * Constructed from marine quality bronze and stainless steel
- * Self-prime from dry up to 3m
- * Easy to service and maintain
- * Will tolerate abrasive wear
- * Handles hard and soft solids without clogging
- * Can pump in either direction
- * Will not airlock

Xylem Water Solutions UK Ltd
Bingley Road
Hoddesdon
Hertfordshire • EN11 0BU UK

Tel: +44 (0)1462 480380
Fax: +44 (0)1462 482422
mail@cleghorn.co.uk
www.jabscoshop.com

