

THE DRAWING AND ALL THE INFORMATION PROVIDED ARE PROPERTY OF LEMMAR LTD AND CANNOT BE REPRODUCED, TRANSFERRED OR MODIFIED WITHOUT PERMISSION. COPYRIGHT LEMMAR LTD.

GENERAL NOTES:--

- 1. ALL DIMENSIONS IN MM UNLESS STATED OTHERWISE
- 2. GENERAL TOLERANCE OF  $\pm 0.2\text{mm}$  UNLESS STATED OTHERWISE
- 3. REMOVE ALL BURRS AND SHARP EDGES
- 4. GENERAL TOLERANCE OF  $+0.1/-0.0$  FOR DRILL HOLES UNLESS STATED OTHERWISE
- 5. ALL ANGULAR DIMENSIONS TO BE  $\pm 0.5^\circ$  UNLESS OTHERWISE SPECIFIED
- 6. M4 BOLTS TO BE TIGHTENED TO  $2.5\text{Nm} \pm 0.5\text{Nm}$
- 7. M5 BOLTS TO BE TIGHTENED TO  $5.0\text{Nm} \pm 1.0\text{Nm}$
- 8. M6 BOLTS TO BE TIGHTENED TO  $9.0\text{Nm} \pm 1.0\text{Nm}$
- 9. M8 BOLTS TO BE TIGHTENED TO  $21.0\text{Nm} \pm 2.0\text{Nm}$
- 10. M10 BOLTS TO BE TIGHTENED TO  $43.0\text{Nm} \pm 3.0\text{Nm}$

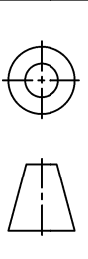
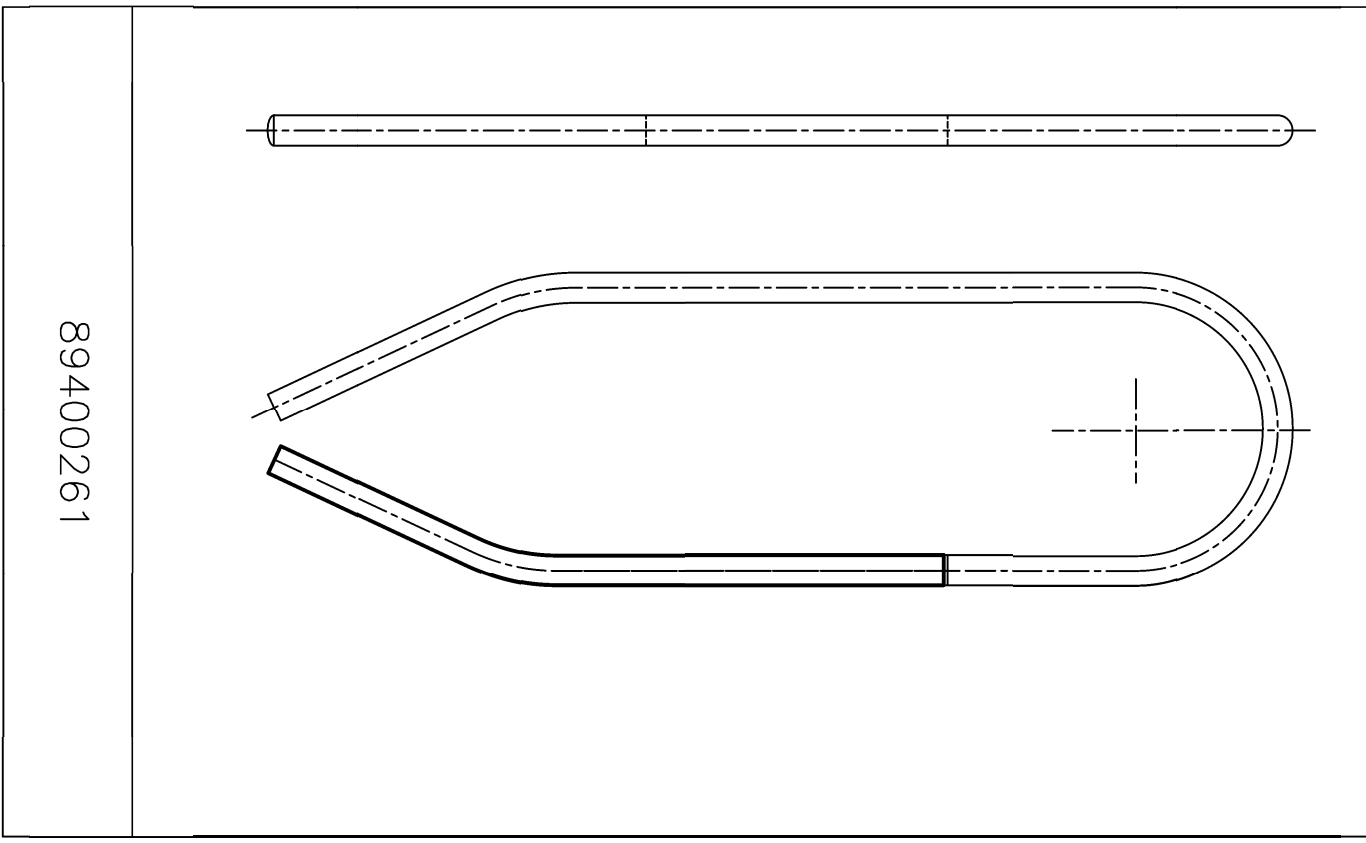
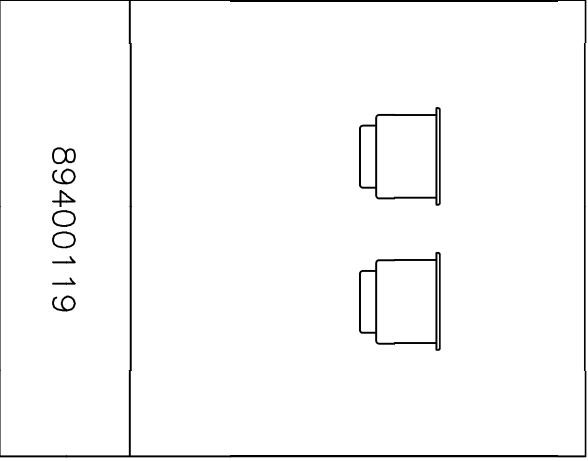
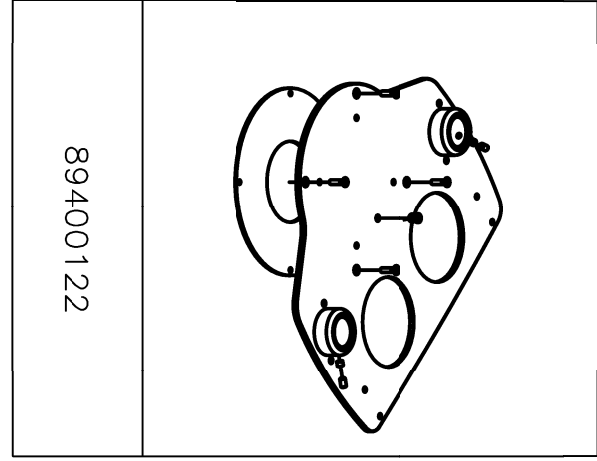

PROJECTION:--

SCALE:--	1:6 @ A3
DRAWN:--	MARK C
DATE:--	08/04/2003
SHEET:--	1 OF 1
CHECK'D:--	

TITLE:--  
ENGUARD ACCESSORY  
KIT

DWG NO:--	89400123	REV	C
<p><b>LEMMAR</b>                  LEMMAR STEERING DIVISION                  1400, 1402, 1404, 1406, 1408, 1410, 1412, 1414, 1416, 1418, 1420, 1422, 1424, 1426, 1428, 1430, 1432, 1434, 1436, 1438, 1440, 1442, 1444, 1446, 1448, 1450, 1452, 1454, 1456, 1458, 1460, 1462, 1464, 1466, 1468, 1470, 1472, 1474, 1476, 1478, 1480, 1482, 1484, 1486, 1488, 1490, 1492, 1494, 1496, 1498, 1500</p>			