

PERFORMANCE:

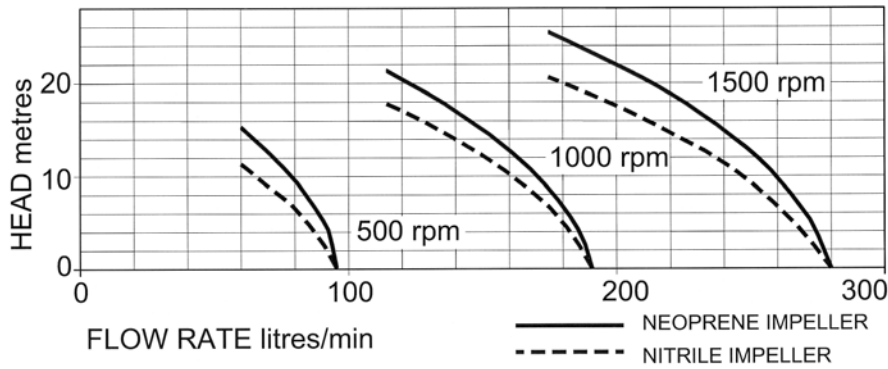

MODEL	Maximum flow rate		Maximum head	
	l/min	gall/min	metres	feet
52270-2011	300	66	25	82
52270-2003	300	66	20	65

Max Power absorbed 1800 watt at 1500rpm

DIMENSIONS:

WEIGHT: 9Kg

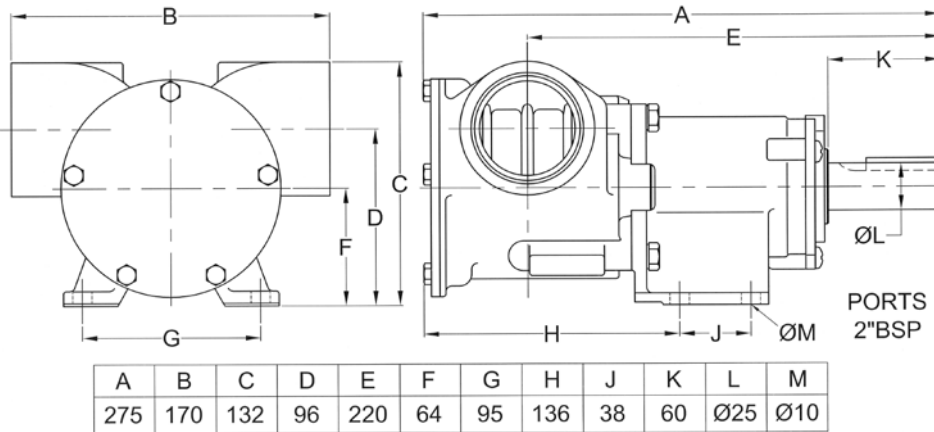

MATERIALS OF CONSTRUCTION:

Body	Bronze
Impeller	Neoprene or Nitrile
Wearplate	Replaceable
Shaft	Stainless steel type 316
Shaft seal	Mechanical, Carbon-Ceramic
Bearings	Twin row, ball type
Port type	2" BSP to BS21 (DIN2999)

MODELS:

52270-2011 Standard Neoprene Impeller

52270-2003 Oil resistant Nitrile

52270-2021 High pressure Neoprene



a xylem brand

**BRONZE FLEXIBLE
IMPELLER PEDESTAL
PUMP**

52270 SERIES



**PUMP with
2" BSP PORTS**

- * Constructed from marine quality bronze and stainless steel
- * Self-prime from dry up to 3m
- * Easy to service and maintain
- * Will tolerate abrasive wear
- * Handles hard and soft solids without clogging
- * Can pump in either direction
- * Will not airlock